

THE EASTWOOD

3,348-4,973 SQ FT LIVING SPACE



Elevation A



Elevation D with optional stone and optional glass door



Elevation B



Elevation C with optional glass door and optional stone

LANDSDALE Modern Farmhouse Renaissance

Lisa Stuart, Sales Manager
301.631.0335 | landsdale@wormald.com
11070 Emerald Crown Drive, Monrovia MD, 21770
Open Daily 11 a.m. - 5 p.m.
by appointment

W
WORMALD

Brokers welcome. MHBR
No. 8295. Prices are
rounded and subject to
change without notice.



EASTWOOD | MAIN LEVEL

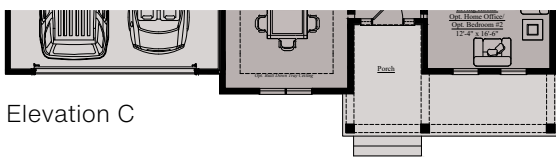
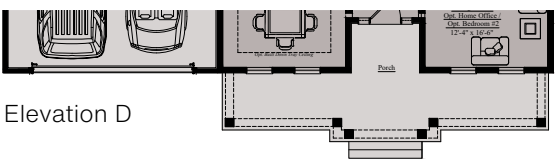
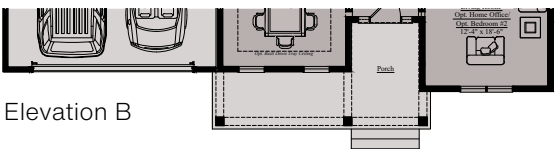
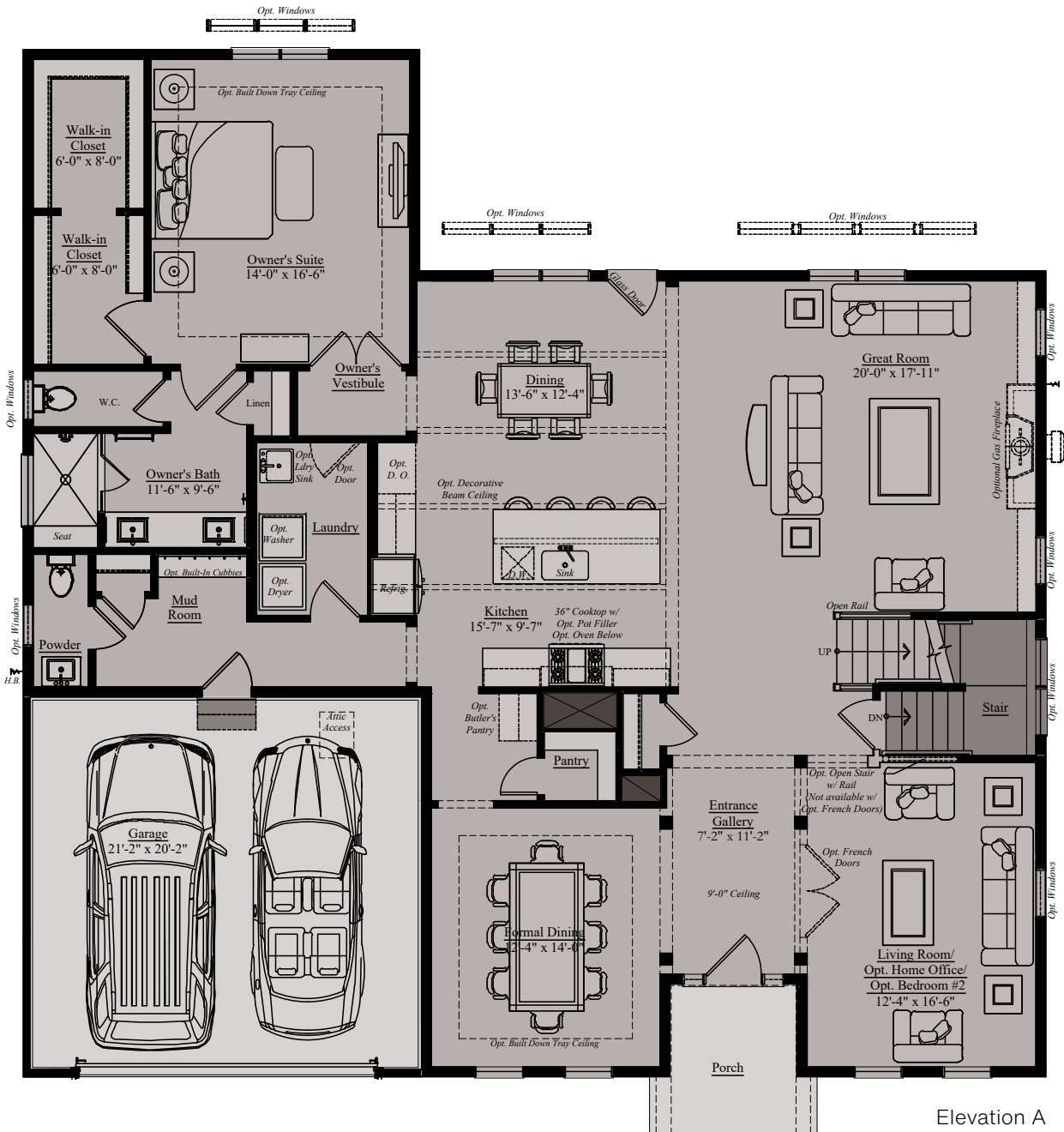

EASTWOOD | UPPER LEVEL

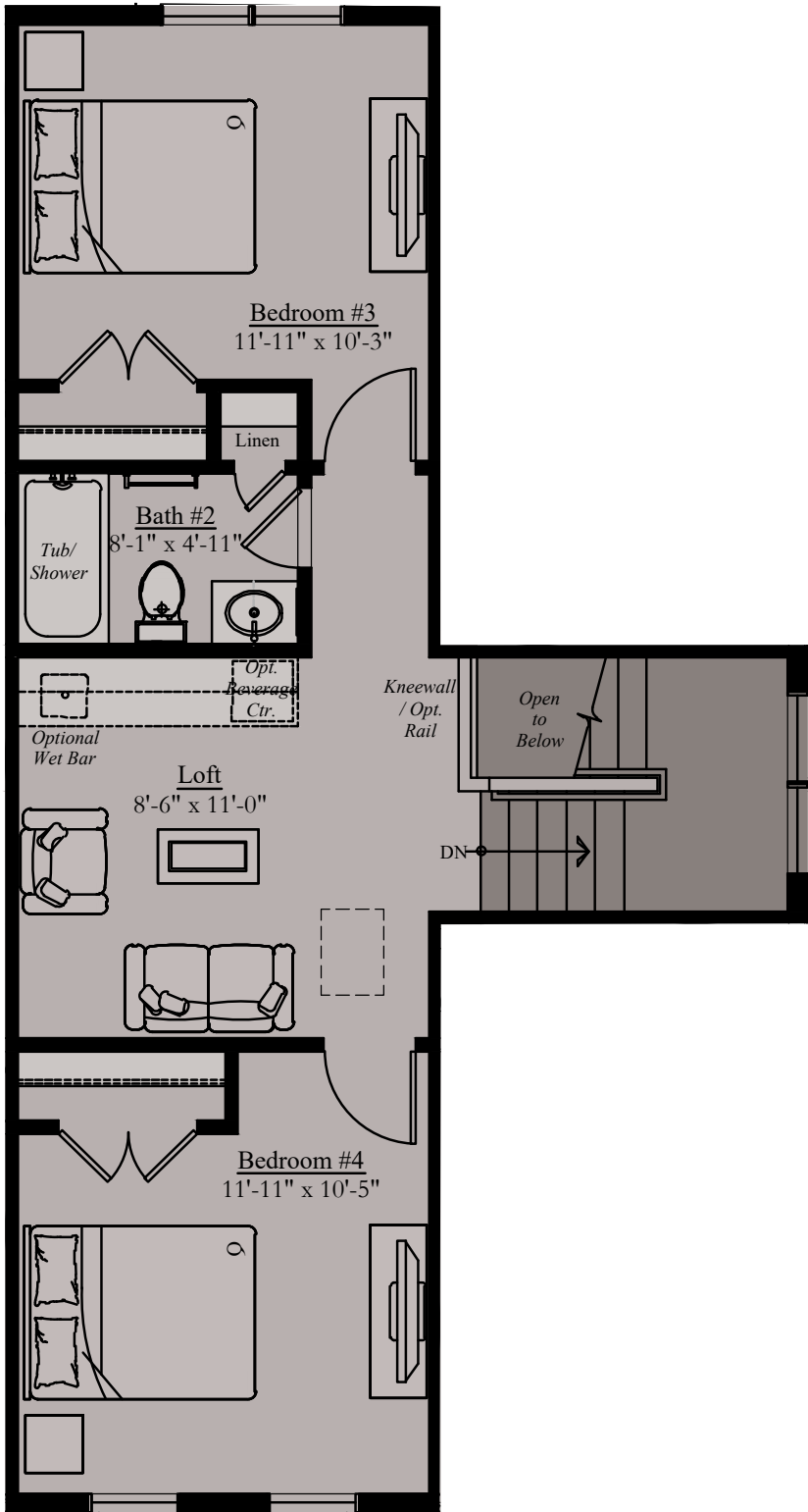

EASTWOOD | OPTIONS

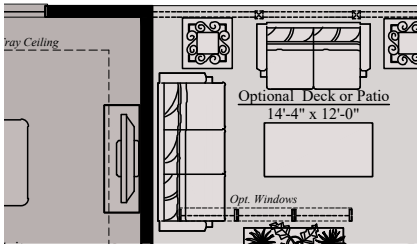

Opt. Screened Porch or Patio

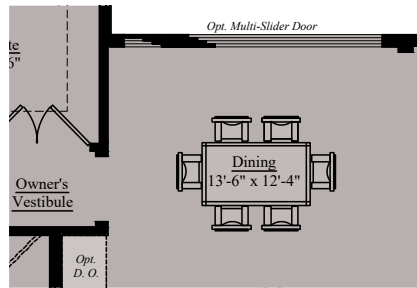

Opt. Multi-Slider Doors

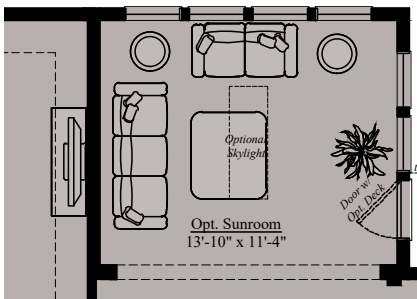

Opt. Sunroom

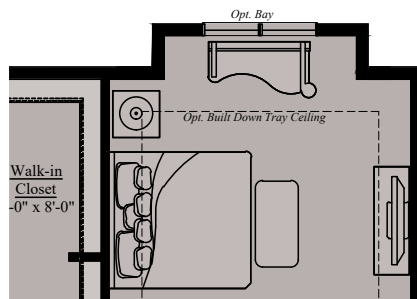

Opt. Box Bay Window

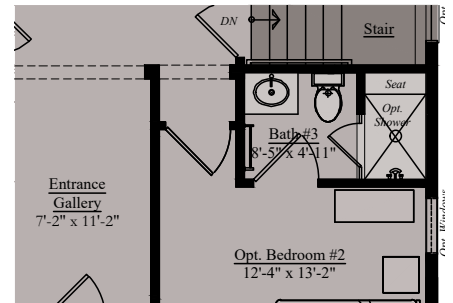

Opt. First Floor Bath

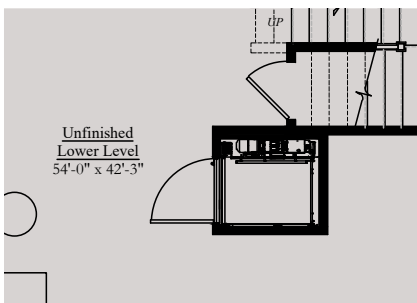

Lower Level Opt. Elevator

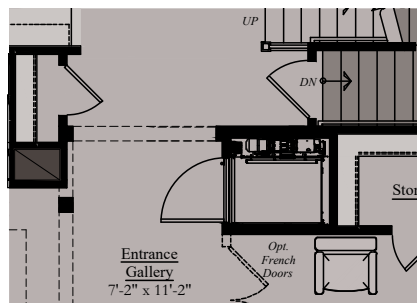

Main Level Opt. Elevator

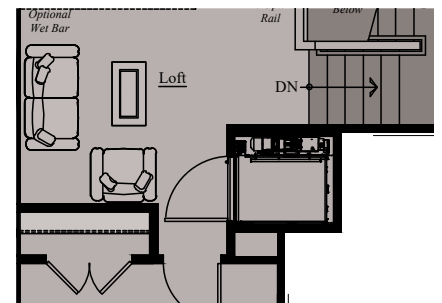

Upper Level Opt. Elevator

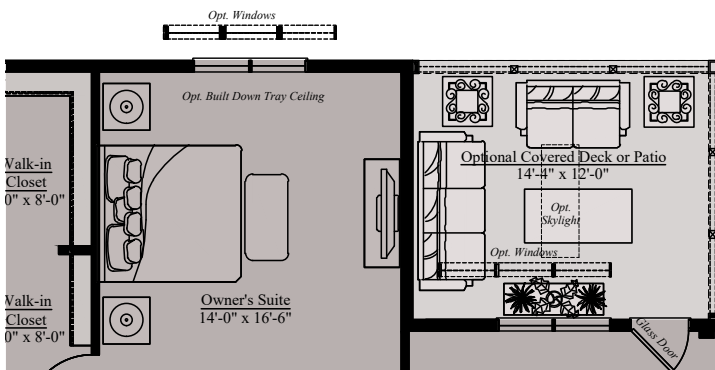

Opt. Deck & Opt. Covered Deck

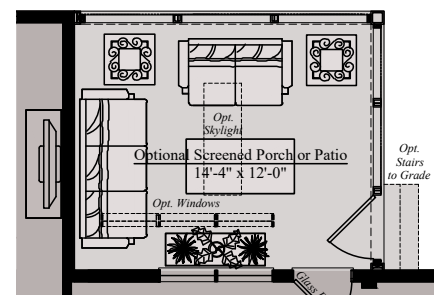

Opt. Covered Deck w/ Screens

EASTWOOD | OPTIONS

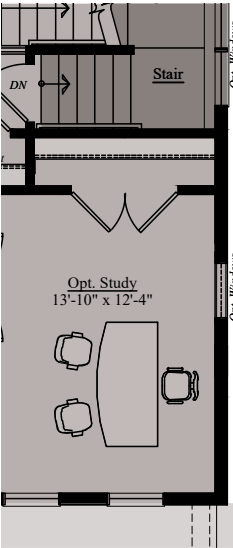

Opt. Study

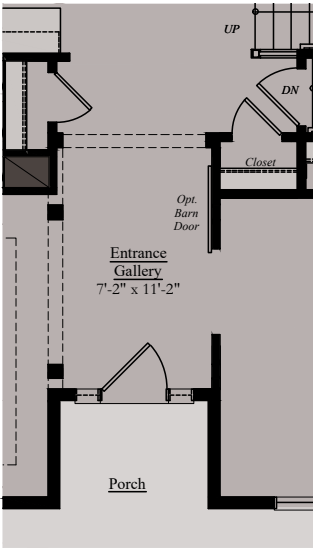

Opt. Main Level Bedroom

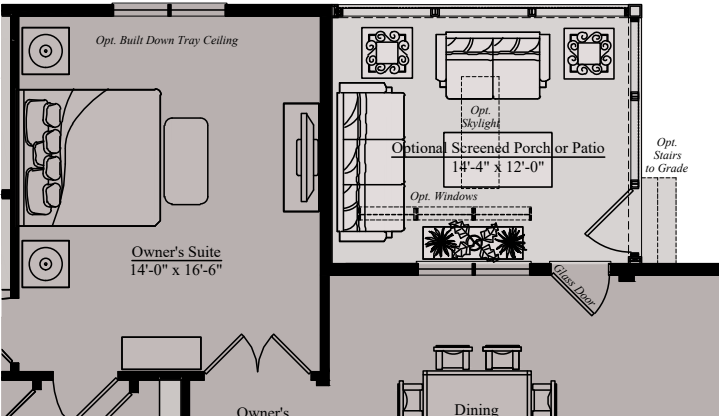
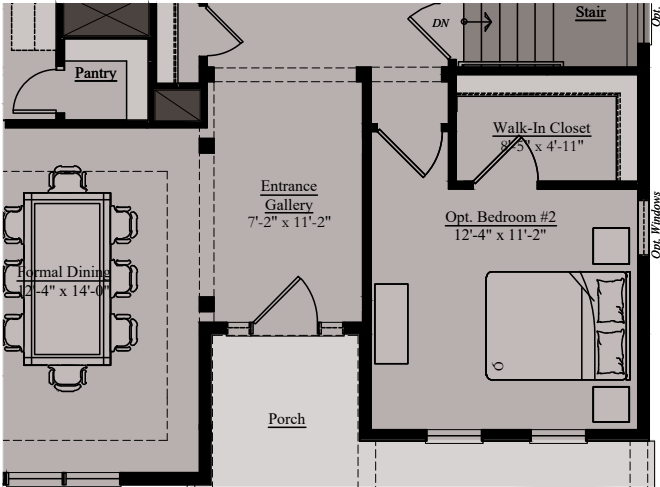

Opt. Screened Porch or Patio

EASTWOOD | LOWER LEVEL

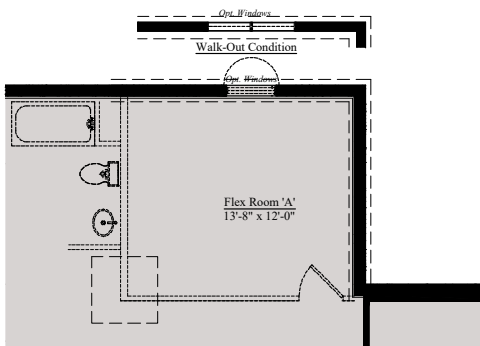
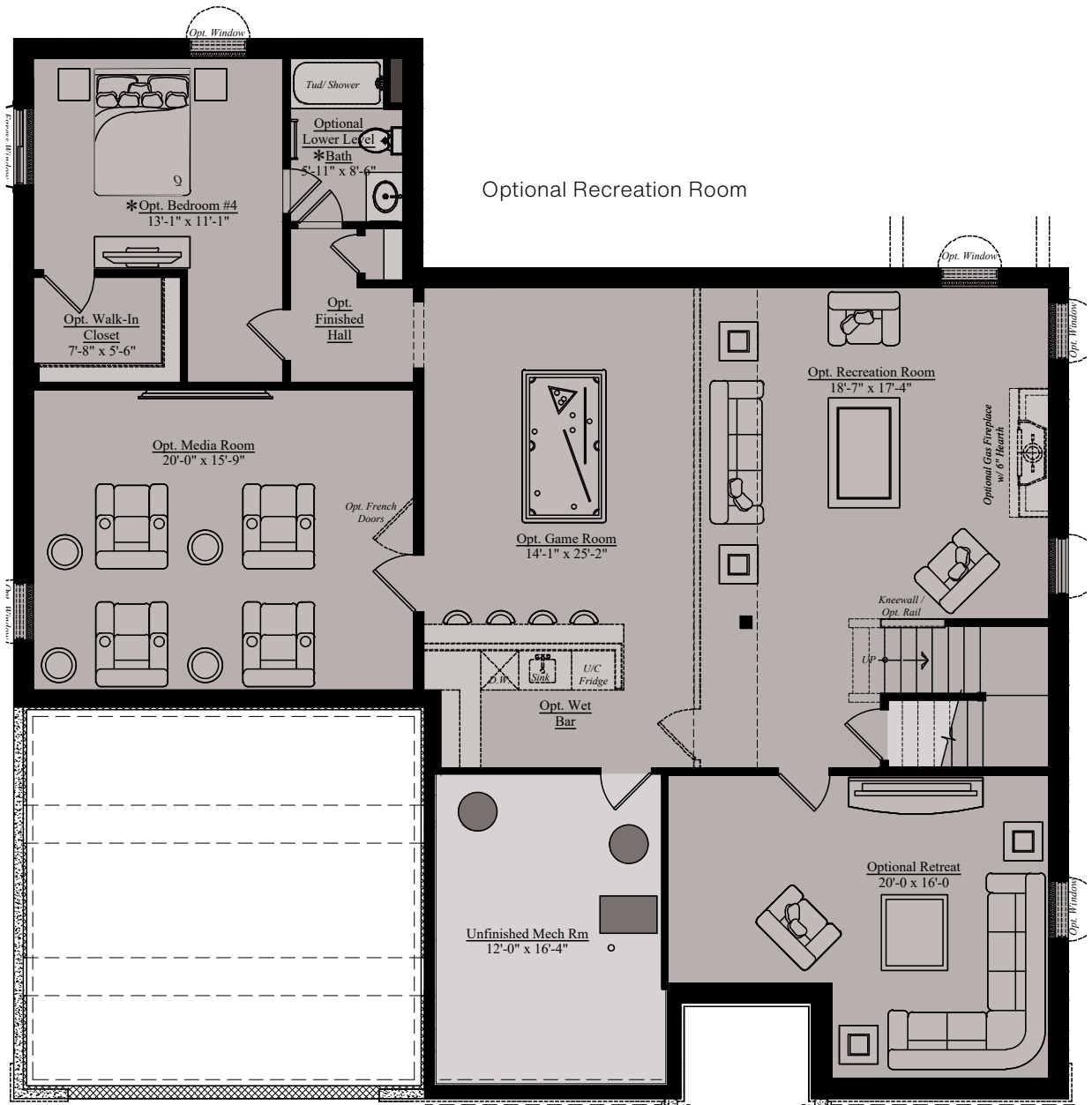

Flex Room with Opt. Sunroom Above

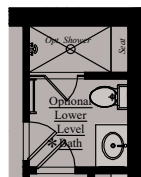

Opt. Shower

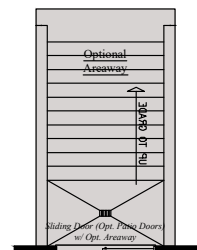

Opt. Areaway

NOTES:

LOVE
WHERE
YOU
LIVE

W
W O R M A L D

www.wormald.com